



BMI USA PLUMBING SPECIALTIES PRICE LIST

**GSP
19-2**

July 16, 2019 (b)

BRASS CLOSET FLANGES

BMI#	Description	Packing	Barcode	\$
28501	LIGHT	1/50	777701285011	20.31
28504	EXTRA HEAVY *	1/25	777701285042	26.03

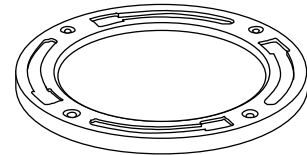

*The extra heavy brass flange is specially designed for uneven floors like cement , ceramic, etc.

SOLID BRASS CLOSET BOLTS ASSEMBLY

BMI#	Description	Packing	Barcode	\$
28500	5/16" x 2 1/4" (60MM)	100/400	777701285004	3.53
28502	5/16" x 2 1/4" (60MM) - Set of 2	50/200	777701285028	7.36
NYLON BOLT SET				
28506	5/16" x 2 1/2" (60MM) - Set of 2	50/500	777701285066	2.42

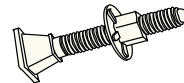
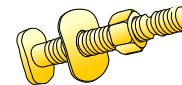

BRASS MARVEL WASTE CONNECTORS

BMI#	Description	Packing	Type	\$
28638	1 1/2 Mips / COP x 1 1/2 / 1 1/4 SLIP	10/100	A	14.06
28646	1 1/2 x 1 1/4 FTG SLIP	10/80	B	21.24
28648	1 1/2 Fips x 1 1/2 or 1 1/4 SLIP	10/50	C	21.24

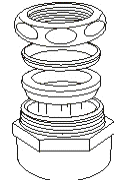
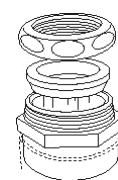

Type "A"

Type "B"

Type "C"

CABLE TIES

WHILE QUANTITIES LAST!

BMI#	Size	Packing	Barcode	\$
WHITE CABLE TIES				
28404	6" WHITE (100 PACK)	10/250	777701284045	2.75
28408	8" WHITE (100 PACK)	10/150	777701284083	5.14
28410	11" WHITE (100 PACK)	10/100	777701284106	7.63
28418	8" WHITE (1000 PACK)	1/15	777701284182	51.28
BLACK CABLE TIES				
28604	6" BLACK (100 PACK)	10/250	777701286049	2.75
28608	8" BLACK (100 PACK)	10/120	777701286087	5.14
28610	11" BLACK (100 PACK)	10/100	777701286100	7.63
28618	8" BLACK (1000 PACK)	1/15	777701286186	51.28



PLASTIC "J" CLIP WITH NAIL

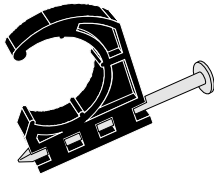

BMI#	Size	Packing	Barcode	\$
28304	1/2	100/1000	777701283048	0.13
28305	3/4	100/500	777701283055	0.19
28306	1	50/250	777701283062	0.28

PLASTIC "D" CLIP WITH NAIL

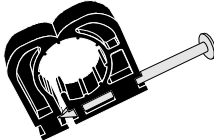

BMI#	Size	Packing	Barcode	\$
28314	1/2	100/4000	777701283147	0.20
28315	3/4	50/2000	777701283154	0.26

PLASTIC "O" CLIP WITH EARS

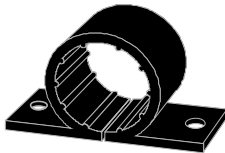

BMI#	Size	Packing	Barcode	\$
28324	1/2	50/2400	777701283246	0.28
28325	3/4	50/1800	777701283253	0.31
28326	1	50/1000	777701283260	0.48

PLASTIC "A" CLIP WITH EARS

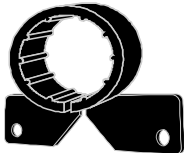

BMI#	Size	Packing	Barcode	\$
28334	1/2	50/2400	777701283345	0.28
28335	3/4	50/1800	777701283352	0.31
28336	1	50/1000	777701283369	0.48

PLASTIC 90° BEND SUPPORT WITH FLANGE



BMI#	Size	Packing	Barcode	\$
28154	1/2	20/500	777701281549	2.38

CPVC BRASS ADAPTERS

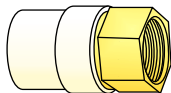

BMI#	Size	Packing	Barcode	\$
CPVC x FIPS				
28704	1/2	25/400	777701287046	7.77
28705	3/4	25/300	777701287053	10.50
28706	1	10/200	777701287060	20.63
28707	1 1/4	10/100	777701287077	29.93
28708	1 1/2	10/60	777701287084	37.80
28709	2	10/40	777701287091	52.24

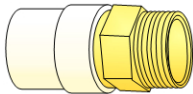

BMI#	Size	Packing	Barcode	\$
CPVC x MIPS				
28804	1/2	25/400	777701288043	8.77
28805	3/4	25/300	777701288050	11.55
28806	1	10/200	777701288067	21.79
28807	1 1/4	10/100	777701288074	29.93
28808	1 1/2	10/60	777701288081	37.80
28809	2	10/40	777701288098	52.24

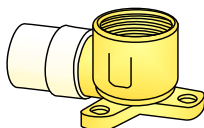

BMI#	Size	Packing	Barcode	\$
CPVC x FIPS 90° ELBOW DROPEAR				
28399	1/2	25/250	777701283994	14.70
28375	3/4	25/100	777701283758	26.10

All taxes extra
All prices in U.S. dollars

2" SHOWER DRAINS CAULK

BMI#	Description	Packing	Barcode	\$
08012	STAINLESS STEEL GRIDS	1/50	777701080128	14.37

WITH RUBBER RINGS
 NO SOLVENT OR M.J. COUPLINGS NEEDED
 SLIP ON 22 ABS, PVC, C.I., OR STEEL PIPES

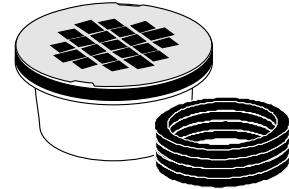

SOLID BRASS SQUEEZE-IN'S

BMI#	Description	Packing	Barcode	\$
08107	2" BACK FLOW PREV.	1/100	777701081071	11.75
08108	3" BACK FLOW PREV.	1/30	777701081088	21.95
08109	4" BACK FLOW PREV.	1/15	777701081095	36.60

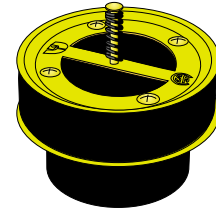

STAINLESS STEEL SNAP-IN'S

BMI#	Description	Packing	Barcode	\$
08031	For 2" pipe (3"outside diam.)	5/180	777701080319	7.07
08032	For 3" pipe (4"outside diam.)	5/150	777701080326	6.57
08033	For 4" pipe (5"outside diam.)	5/80	777701080333	10.37

