

# LISTE DE PRIX BMI CANADA RACCORDS EN FONTE TARAUDÉS

**CFT**  
**18-1**

19 mars 2018

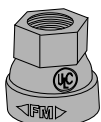

MANCHONS RÉD. HEXAGONAUX			
#BMI	Taille	Emballage	\$
15027	1 x 3/4	90	19.67
15028	1 x 1/2	100	13.83

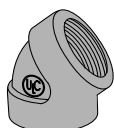

COUDES 45°			
#BMI	Taille	Emballage	\$
15204	1/2	150	9.56
15205	3/4	120	13.07
15206	1	70	19.28
15207	1 1/4	40	29.65
15208	1 1/2	30	38.02
15209	2	15	58.09

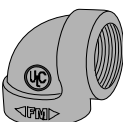

COUDES 90°			
#BMI	Taille	Emballage	\$
15304	1/2	150	9.60
15305	3/4	120	13.07
15306	1	60	19.11
15307	1 1/4	35	28.71
15308	1 1/2	25	37.91
15309	2	15	58.09

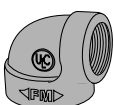

COUDES RÉDUITS 90°			
1"			
#BMI	Taille	Emballage	\$
15327	1 x 3/4	70	17.58
15328	1 x 1/2	90	17.06

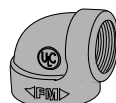

COUDES RÉDUITS 90°			
#BMI	Taille	Emballage	\$
1 1/4"			
15331	1 1/4 x 1	40	26.44
15332	1 1/4 x 3/4	60	23.18
15333	1 1/4 x 1/2	65	21.82

1 1/2"			
#BMI	Taille	Emballage	\$
15335	1 1/2 x 1 1/4	30	37.64
15336	1 1/2 x 1	30	37.64
15337	1 1/2 x 3/4	30	37.64
15338	1 1/2 x 1/2	35	37.64

2"			
#BMI	Taille	Emballage	\$
15340	2 x 1 1/2	22	55.74
15342	2 x 1	25	55.74
15343	2 x 3/4	30	55.74
15344	2 x 1/2	30	55.74

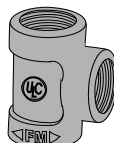

TÉS			
#BMI	Taille	Emballage	\$
15404	1/2	100	17.56
15405	3/4	60	21.19
15406	1	45	25.47
15407	1 1/4	30	42.34
15408	1 1/2	18	57.89
15409	2	12	80.25



## RACCORDS EN FONTE TARAUDÉS

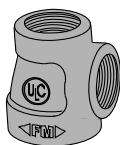

TÉS RÉDUITS			
#BMI	Taille	Emballage	\$

### 1/2"

15420	1/2 x 1/2 x 3/4	60	17.03
-------	-----------------	----	-------

### 1"

15436	1 x 1 x 1 1/2	36	45.53
15437	1 x 1 x 1 1/4	40	34.11
15438	1 x 1 x 3/4	50	25.60
15440	1 x 1 x 1/2	60	23.02
15442	1 x 3/4 x 1	50	26.33
15443	1 x 3/4 x 3/4	60	20.99
15448	1 x 1/2 x 1	50	25.38

### 1 1/4"

15451	1 1/4 x 1 1/4 x 2	20	65.03
15452	1 1/4 x 1 1/4 x 1 1/2	25	50.75
15453	1 1/4 x 1 1/4 x 1	35	38.17
15454	1 1/4 x 1 1/4 x 3/4	40	36.36
15455	1 1/4 x 1 1/4 x 1/2	45	37.39
15463	1 1/4 x 1 x 1 1/2	25	45.03

### 1 1/4"

15457	1 1/4 x 1 x 1 1/4	30	40.81
15458	1 1/4 x 1 x 1	42	38.89
15459	1 1/4 x 1 x 3/4	45	34.11
15460	1 1/4 x 1 x 1/2	45	46.71
15462	1 1/4 x 3/4 x 1	45	41.64

### 1 1/2"

15470	1 1/2 x 1 1/2 x 2	16	76.05
15471	1 1/2 x 1 1/2 x 1 1/4	20	54.51
15472	1 1/2 x 1 1/2 x 1	25	51.23
15473	1 1/2 x 1 1/2 x 3/4	30	52.14
15474	1 1/2 x 1 1/2 x 1/2	30	52.22
15475	1 1/2 x 1 1/4 x 2	18	71.24

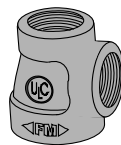

TÉS RÉDUITS			
#BMI	Taille	Emballage	\$

### 1 1/2"

15476	1 1/2 x 1 1/4 x 1 1/2	20	71.24
15570	1 1/2 x 1 1/4 x 1 1/4	20	59.11
15477	1 1/2 x 1 1/4 x 1	25	46.11
15478	1 1/2 x 1 1/4 x 3/4	32	44.53
15479	1 1/2 x 1 1/4 x 1/2	32	41.35
15572	1 1/2 x 1 x 2	18	72.93
15480	1 1/2 x 1 x 1 1/2	20	51.28
15481	1 1/2 x 1 x 1 1/4	25	52.44
15482	1 1/2 x 1 x 1	30	53.74
15483	1 1/2 x 1 x 3/4	20	46.65
15484	1 1/2 x 1 x 1/2	20	46.65
15485	1 1/2 x 3/4 x 1 1/2	30	52.44

### 2"

15494	2 x 2 x 1 1/2	15	84.18
15495	2 x 2 x 1 1/4	15	78.25
15496	2 x 2 x 1	18	67.40
15497	2 x 2 x 3/4	18	63.76
15498	2 x 2 x 1/2	18	63.76
15530	2 x 1 1/2 x 2	15	96.70
15531	2 x 1 1/2 x 1 1/2	18	71.97
15533	2 x 1 1/2 x 1	18	62.29
15534	2 x 1 1/2 x 3/4	25	63.58
15535	2 x 1 1/2 x 1/2	20	58.09
15540	2 x 1 1/4 x 2	12	89.03
15543	2 x 1 1/4 x 1	18	60.21
15550	2 x 1 x 2	12	81.62
15552	2 x 1 x 1 1/4	16	61.85
15560	2 x 3/4 x 2	16	81.82
15561	2 x 1/2 x 2	18	80.11

